

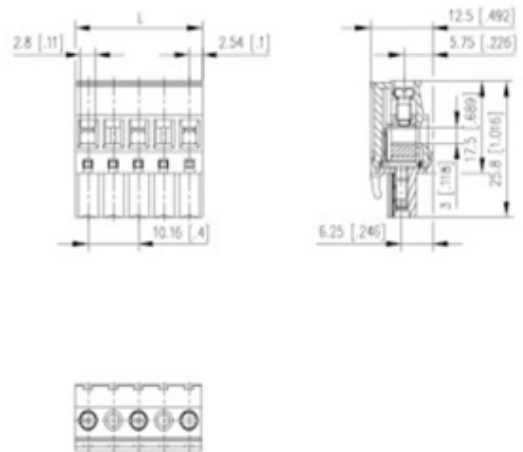

# Plug and Socket PCB Terminal Blocks

Range: PCB Terminal Blocks, Connectors and Fuse Holders

Order Code: 31213206



## DESCRIPTION

6 Pole horizontal screw female plug terminal block 10.16mm pitch 13.5A 630V

*Subject to technical modification without notice.*

*Typographical and other errors do not justify claim for damages.*

## SPECIFICATION

|                             |   |
|-----------------------------|---|
| Type                        | Cable mount - Female plug   |
| Connection Method           | Screw   |
| Mounting Type               | Rising clamp  |
| Orientation                 | Horizontal  |
| Join                        | Solid body non stackable  |
| Pitch (mm)                  | 10.16   |
| Number of Poles             | 6   |
| Max Current (A)             | 13.5  |
| Max Voltage (V)             | 630   |
| Height (mm)                 | 25.8  |
| Standard Colour             | Black   |
| Width (mm)                  | 12.5  |
| Length (mm)                 | 55.88   |
| Comments                    | Pole sizes / no of ways not shown, please contact us for availability |
| IP Rating                   | 20  |
| Min Temperature Rating °C   | 12  |
| Min Wire Size AWG           | 28  |
| Pin Style                   | Pluggable   |
| Tracking Resistance CTI (v) | 600   |

## INDUSTRY ACCREDITATIONS

