

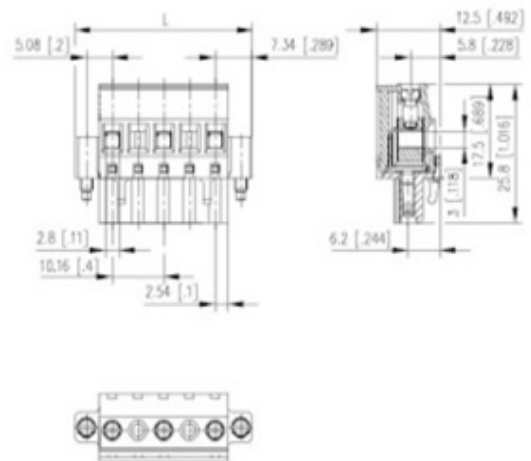

# Plug and Socket PCB Terminal Blocks

Range: PCB Terminal Blocks, Connectors and Fuse Holders

Order Code: 31218203



## DESCRIPTION

3 Pole horizontal screw female plug terminal block 10.16mm pitch 13.5A 630V

*Subject to technical modification without notice.*

*Typographical and other errors do not justify claim for damages.*

## SPECIFICATION

Type	Cable mount - Female plug
Connection Method	Screw
Mounting Type	Rising clamp
Orientation	Horizontal
Join	Solid body non stackable
Pitch (mm)	10.16
Open/Closed/Screw/Flange	Screw flange
Number of Poles	3
Min Wire Size (Sq mm)	1
Max Wire Size (Sq mm)	2.5
Max Current (A)	13.5
Max Voltage (V)	630
Height (mm)	25.8
Standard Colour	Black
Width (mm)	12.5
Length (mm)	35
Comments	Pole sizes / no of ways not shown, please contact us for availability
IP Rating	20
Min Temperature Rating °C	12
Min Wire Size AWG	28
Pin Style	Pluggable
Tracking Resistance CTI (v)	600

## INDUSTRY ACCREDITATIONS

