

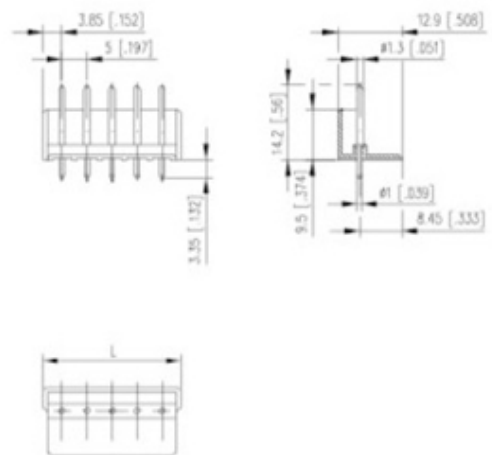

# Plug and Socket PCB Terminal Blocks

Range: PCB Terminal Blocks, Connectors and Fuse Holders

Order Code: 31042110



## DESCRIPTION

10 Pole vertical pin headers 5mm pitch 10A 250V

*Subject to technical modification without notice.*

*Typographical and other errors do not justify claim for damages.*

## SPECIFICATION

<b>Type</b>	PCB mount - Male header
<b>Mounting Type</b>	Wave - through hole
<b>Orientation</b>	Vertical
<b>Pitch (mm)</b>	5
<b>Number of Poles</b>	10
<b>Max Current (A)</b>	10
<b>Max Voltage (V)</b>	250
<b>Height (mm)</b>	14.2
<b>Standard Colour</b>	Black
<b>Width (mm)</b>	12.9
<b>Length (mm)</b>	52.7
<b>Solder Pin Length (mm)</b>	3.35
<b>PCB Hole Diameter (mm)</b>	1.3
<b>Comments</b>	Pole sizes / no of ways not shown, please contact us for availability
<b>Pin Style</b>	Solderable
<b>Tracking Resistance CTI (v)</b>	600