

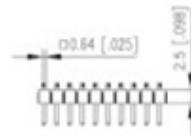

# Board to Board Connectors

Range: PCB Terminal Blocks, Connectors and Fuse Holders

Part Number: PM20210VBDN

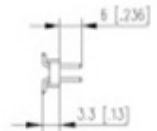
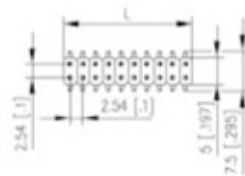

## DESCRIPTION

10 Pole vertical pin headers 2.54mm pitch 3A

*Subject to technical modification without notice.*

*Typographical and other errors do not justify claim for damages.*

## SPECIFICATION

<b>Orientation</b>	Vertical
<b>Pitch (mm)</b>	2.54
<b>Number of Poles</b>	10
<b>Max Current (A)</b>	3
<b>Standard Colour</b>	Black
<b>Length (mm)</b>	25.4
<b>Pin Style</b>	Solderable